

CRSH3 SERIES
SILICON SCHOTTKY RECTIFIER
3 AMP, 20 THRU 100 VOLTS



DO-201AD CASE



www.centrasemi.com

DESCRIPTION:

The CENTRAL SEMICONDUCTOR CRSH3 series types are 3.0 amp glass passivated silicon Schottky rectifiers mounted in an axial-lead epoxy case using a metal-to-silicon junction to yield low forward voltage drops and instantaneous reverse recovery time.

MARKING: FULL PART NUMBER

MAXIMUM RATINGS: ($T_A=25^{\circ}\text{C}$ unless otherwise noted)

		CRSH3							
	SYMBOL	-2	-3	-4	-5	-6	-8	-10	UNITS
Peak Repetitive Reverse Voltage	V_{RRM}	20	30	40	50	60	80	100	V
DC Blocking Voltage	V_R	20	30	40	50	60	80	100	V
RMS Reverse Voltage	$V_{R(RMS)}$	14	21	28	35	42	56	70	V
Average Forward Current	I_O				3.0				A
Peak Forward Surge Current ($t_p=8.3\text{ms}$)	I_{FSM}				80				A
Operating Junction Temperature	T_J				-65 to +125				$^{\circ}\text{C}$
Storage Temperature	T_{stg}				-65 to +150				$^{\circ}\text{C}$
Thermal Resistance	Θ_{JL}				20				$^{\circ}\text{C/W}$

ELECTRICAL CHARACTERISTICS: ($T_A=25^{\circ}\text{C}$ unless otherwise noted)

SYMBOL	TEST CONDITIONS	TYP	MAX	UNITS
I_R	$V_R=\text{Rated } V_{RRM}$		0.5	mA
I_R	$V_R=\text{Rated } V_{RRM}, T_A=100^{\circ}\text{C}$		30	mA
V_F	$I_F=3.0\text{A}$ (20V, 30V, 40V)		0.55	V
V_F	$I_F=3.0\text{A}$ (50V, 60V)		0.75	V
V_F	$I_F=3.0\text{A}$ (80V, 100V)		0.85	V
C_J	$V_R=4.0\text{V}, f=1.0\text{MHz}$	250		pF

R2 (18-June 2012)

CRSH3 SERIES
SILICON SCHOTTKY RECTIFIER
3 AMP, 20 THRU 100 VOLTS



DO-201AD CASE - MECHANICAL OUTLINE

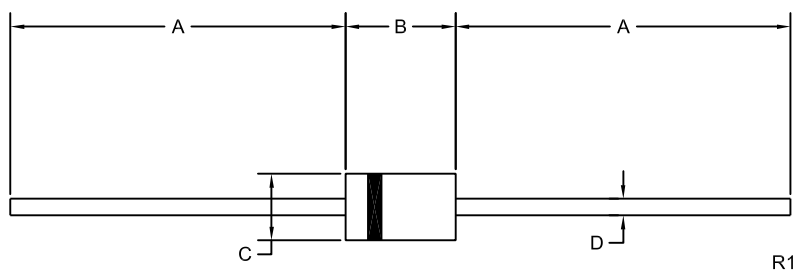

DIMENSIONS				
SYMBOL	INCHES		MILLIMETERS	
	MIN	MAX	MIN	MAX
A	1.000	-	25.40	-
B	0.283	0.375	7.20	9.53
C	0.189	0.210	4.80	5.33
D	0.047	0.052	1.20	1.32

DO-201AD (REV: R1)

MARKING: FULL PART NUMBER

R2 (18-June 2012)

OUTSTANDING SUPPORT AND SUPERIOR SERVICES



PRODUCT SUPPORT

Central's operations team provides the highest level of support to insure product is delivered on-time.

- Supply management (Customer portals)
- Inventory bonding
- Consolidated shipping options
- Custom bar coding for shipments
- Custom product packing

DESIGNER SUPPORT/SERVICES

Central's applications engineering team is ready to discuss your design challenges. Just ask.

- Free quick ship samples (2nd day air)
- Online technical data and parametric search
- SPICE models
- Custom electrical curves
- Environmental regulation compliance
- Customer specific screening
- Up-screening capabilities
- Special wafer diffusions
- PbSn plating options
- Package details
- Application notes
- Application and design sample kits
- Custom product and package development

REQUESTING PRODUCT PLATING

1. If requesting Tin/Lead plated devices, add the suffix "TIN/LEAD" to the part number when ordering (example: 2N2222A TIN/LEAD).
2. If requesting Lead (Pb) Free plated devices, add the suffix "PBFREE" to the part number when ordering (example: 2N2222A PBFREE).

CONTACT US

Corporate Headquarters & Customer Support Team

Central Semiconductor Corp.
145 Adams Avenue
Hauppauge, NY 11788 USA
Main Tel: (631) 435-1110
Main Fax: (631) 435-1824
Support Team Fax: (631) 435-3388
www.centrasemi.com

Worldwide Field Representatives:
www.centrasemi.com/wwreps

Worldwide Distributors:
www.centrasemi.com/wwdistributors

For the latest version of Central Semiconductor's **LIMITATIONS AND DAMAGES DISCLAIMER**, which is part of Central's Standard Terms and Conditions of sale, visit: www.centrasemi.com/terms